

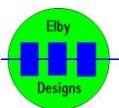

Studio Series (300, 500 & 700)

General Assembly Guide

Revision 1.0
April 15th, 2010



Studio Series Enclosures

The following discussion uses the Studio 500 as an example but this discussion refers to equally to the Studio 300 and Studio 700 but uses fewer bolts.

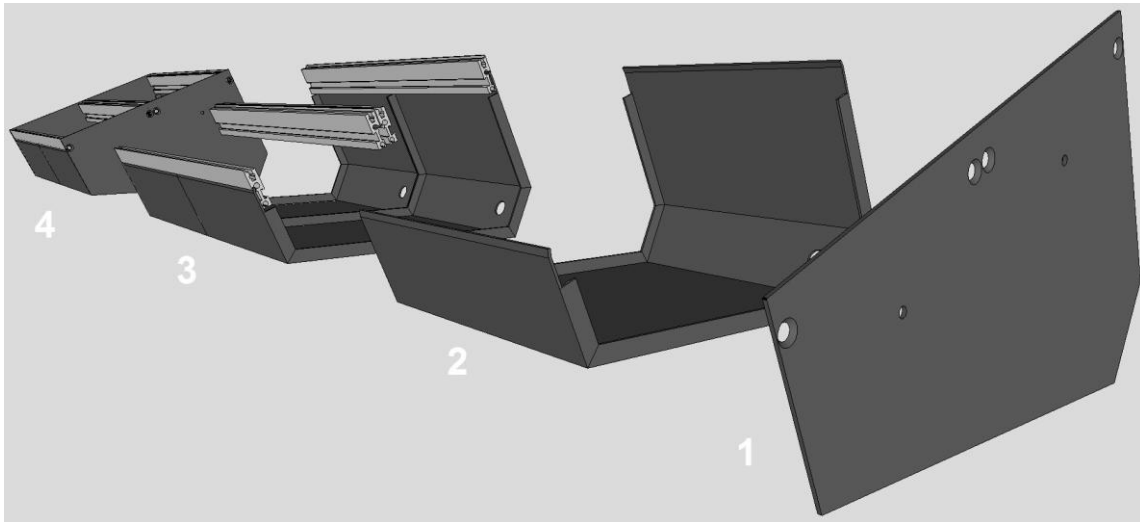

Join the skin sections (2) together using the M4 pan head bolts supplied

Install the M4 cup washers on to the appropriate busboard mounting locations as show at right. The washers are cupped on one side and this side should be placed over the bolt first so that the larger flat surface remains exposed.



Fit 8x M3x 12mm bolts to the Busboard Mounting Plate and secure using the M3 x 5mm nylon spacers as shown at left.

Mount the Busboard Carrier Assembly in to the skins and secure using the M4 Nut-Washers

Install busboards and secure using 8x M3 nuts. If more than one busboard has been installed then fit the appropriate interconnect kits

Fit one of the end plates (1) using the M4 countersunk screws provided.
Attach Rails (3) using the M5 countersunk bolts.
Insert Tapped Strips (or Rail Nuts).
Attach the other end plate (1) to the Rails using M5 countersunk bolts.
Secure the end plate to the skin using M4 countersunk bolts.

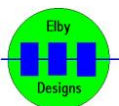

Elby Designs - Laurie Biddulph

9 Follan Close, Kariong, NSW 2250, Australia

elby_designs@ozemail.com.au <http://www.elby-designs.com>

Studio Series Enclosures

NB: Aluminium does what is sometimes called 'cold welding' which effectively means that any securing bolts can become locked and extremely difficult to undo. If you plan to regularly disassemble your system (to add/remove sliding nuts for example) then you should consider wiping a tiny amount of clear grease on to the bolt threads before inserting.

Studio End Cheeks

If fitting End Cheeks then fit them now. Note that the Studio 300 and Studio 700 End Cheeks and integrated feet in their profile and these must be positioned at the back/bottom of the assembly. Secure using M6 countersunk screws.

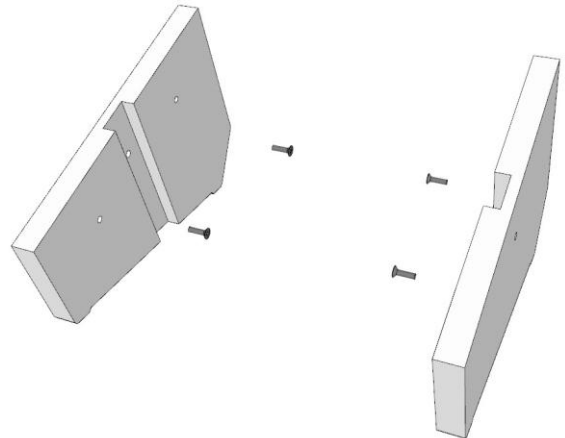

Studio Lid Assembly

Assembly of the Studio 300 Lid is the same as described above although there are only 2 external rails and no internal rails fitted.

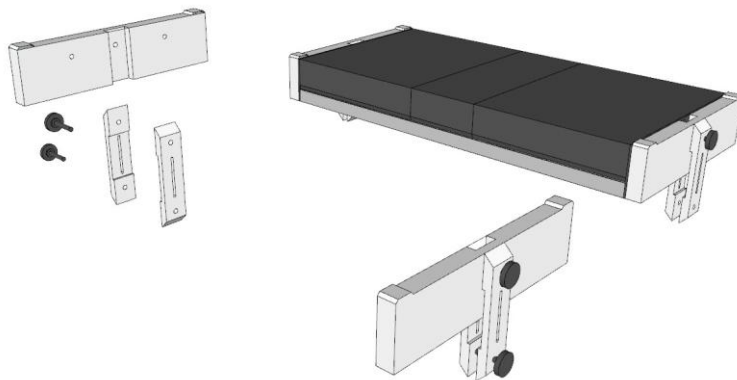
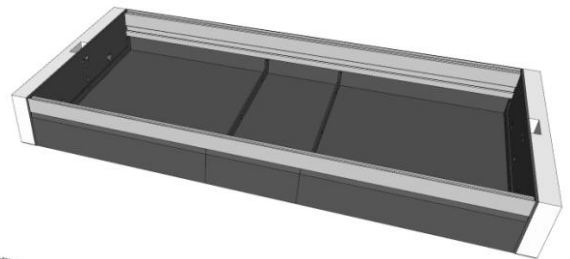

To mount the lid on to a Studio enclosure will require a Studio Enclosure Lid Kit which comprises 4x Biscuits and 4x Thumbwheels as shown at left.

The Biscuits are inserted in to the slots in the lid assembly with the recess in each pair facing towards each other. The Biscuits are secured to the lid section using 2x Thumbwheels.

When fitting the lid to an enclosure, guide the Biscuits in to the mating slots on the enclosure and then secure with the 2nd pair of thumbwheels.

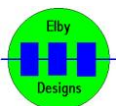
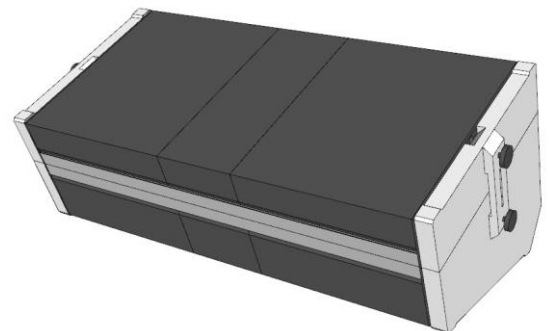

Elby Designs - Laurie Biddulph

9 Follan Close, Kariong, NSW 2250, Australia

elby_designs@ozemail.com.au <http://www.elby-designs.com>

Studio Series Enclosures

Studio Strap

A Studio Strap may be fitted to a lid to assist with carrying an enclosure.

The strap must be fitted to the outer Biscuits of the lid assembly.

- Feed the Strap through the 2 buckles.
- Feed the ends of the Straps through the slot in the Biscuits.
- Feed the ends of the Strap back through the buckle.
- Fit the Strap assembly to your enclosure and adjust the buckles for the desired length.



Studio Tree

The Studio Tree allows 1 or 2 Studio 700 or Studio 300 boats to be raised above the desktop and sit with a Studio 500 to form a 12U or 18U system.

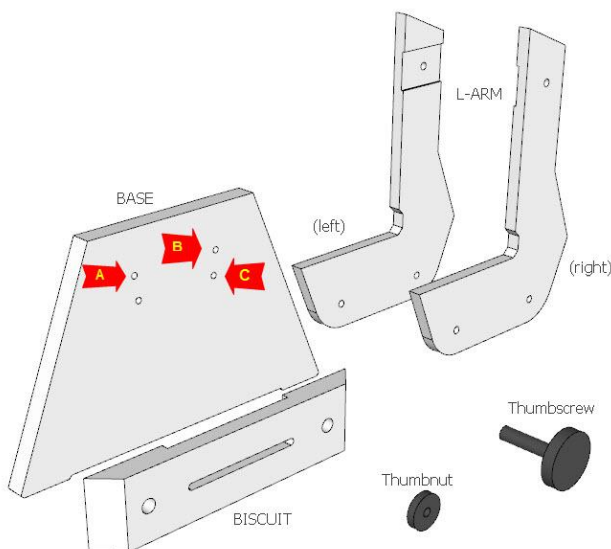

The Studio Tree comprises

- 1x L-Arm left
- 1x L-Arm right
- 2x Biscuit
- 2x Base
- 6x Thumbscrew
- 6x Thumbnut

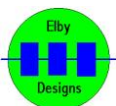

Elby Designs - Laurie Biddulph

9 Follan Close, Kariong, NSW 2250, Australia

elby_designs@ozemail.com.au <http://www.elby-designs.com>

Studio Series Enclosures

Two configurations are offered:-

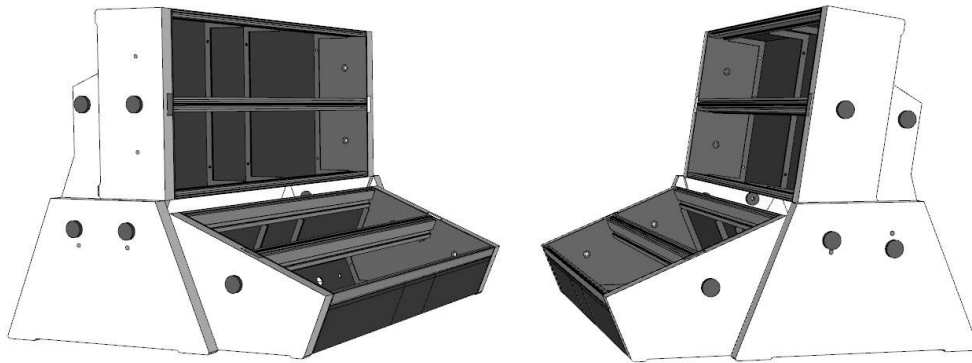

1. Vertical as shown at left
2. Sloped as shown at right

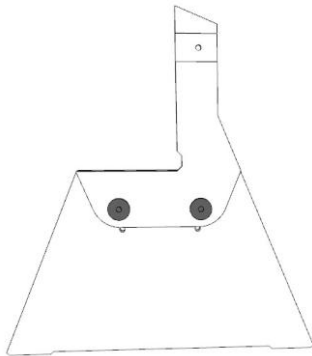

The choice of configuration is made from the choice of the location of one of the Thumbnuds:-

Position [B] for the vertical configuration or position [C] for the sloped configuration.

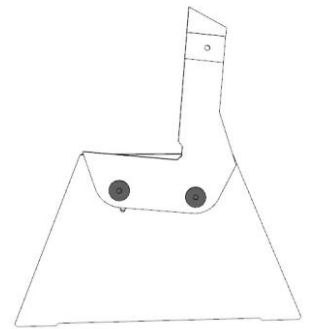

The user can switch configurations by loosening Thumbnut [A] and removing and relocating the [B]/[C] Thumbscrew.

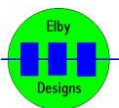
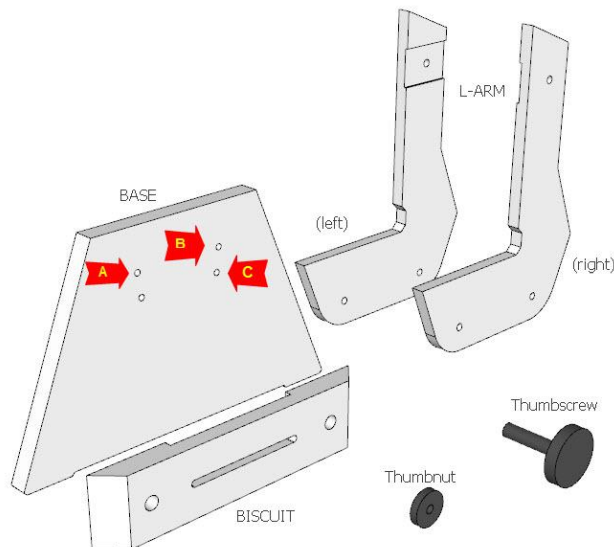

Elby Designs - Laurie Biddulph

9 Follan Close, Kariong, NSW 2250, Australia

elby_designs@ozemail.com.au <http://www.elby-designs.com>

Studio Series Enclosures

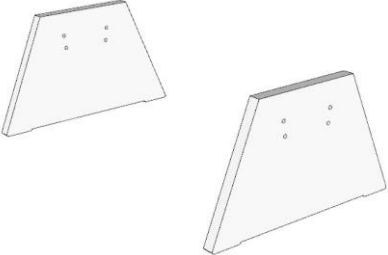
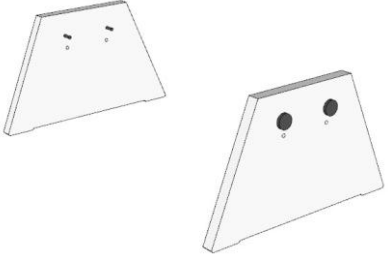
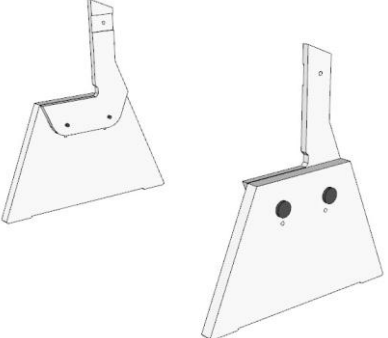
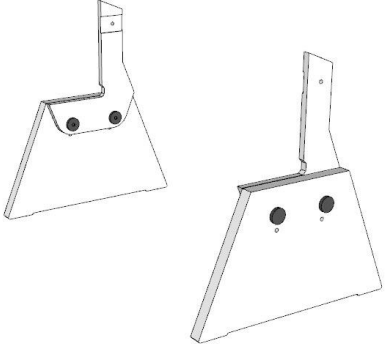
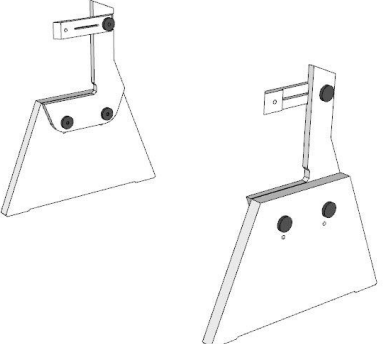
| | |
|--|---|
| <p>Start with the 2 BASE parts. Although these are universal parts and so can be used either way, there is a protective film on one side which would indicate the outer face for initial assembly.</p> |  |
| <p>Insert 2 Thumbscrews in to each part. Use positions [A] and [B] for the vertical configuration or Positions [A] and [C] for the sloped configuration.</p> |  |
| <p>Position the L-ARM on to the Thumbscrews in the BASE.</p> |  |
| <p>Secure using Thumbnuts.</p> |  |
| <p>Position the BISCUITS with the recessed section facing outwards. Secure using a Thumbscrew and Thumbnut.</p> |  |

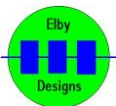

Elby Designs - Laurie Biddulph

9 Follan Close, Kariong, NSW 2250, Australia

elby_designs@ozemail.com.au <http://www.elby-designs.com>

Studio Series Enclosures

Slide the boat on to the exposed BISCUIT section.
The boat can be either a Studio 700 or a Studio 300.



Secure the boat using 2x Thumbscrews.



A Studio 500 may now be positioned in the front area of the
unit or the space may be used for other equipment as
required.

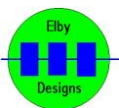

Elby Designs - Laurie Biddulph

9 Follan Close, Kariong, NSW 2250, Australia

elby_designs@ozemail.com.au <http://www.elby-designs.com>